INDUCTION COUPLING

SS316

GENERAL SPECIFICATION

Product Family
Voltage supply
Operating temperature range Ta
Maintenance & cleaning
Sources of light
Brand of sources
Mac Adam range
Life time L80B10 at 25° C
Life time L70B50 at Ta Max
Brand of Driver
Cycles on/off
Ripple current
Position driver on fixture
Body material
Diffuser material
Reflector material
Closing clips material
Electrical network interface
Surge protection
Vandal proof
Through wiring

LIFE TIME AND WARRANTY

Nominal life time	50000hrs
Warranty	5 years

NORMS & DIRECTIVES

Nominal norms marking	CE /TUV/GS
CE directive	CEI 60598-1 CEI 60598-2-2 : 2012
Security Photobiological	CEI 62471 - : 2008 : RG0
Inflammable surface compliancy	F
Other marking	ASTM B117

OPTIONS

Dimming	NONE
CCT color temperature	3000K [3]; 5000k [5]; 6000K [6]; Blue [B]; Green [G]; Red [G]
CRI color rendering index	-
Coulor of product	-
Reflector/Optic	-
Mounting accessories	Earth pole [LX002]; concrete bascket [LX001]
Other option	-

Installation instructions

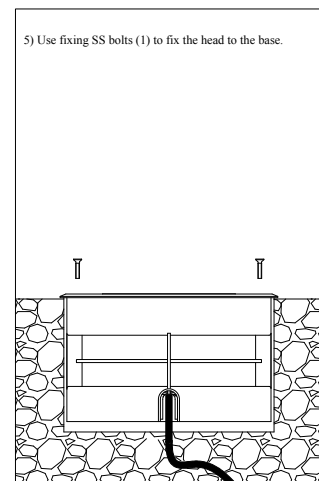
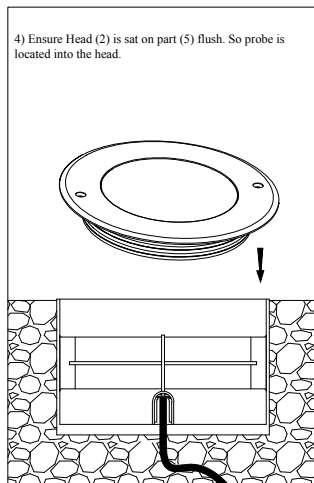
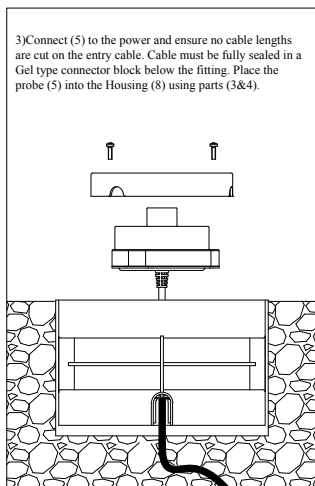
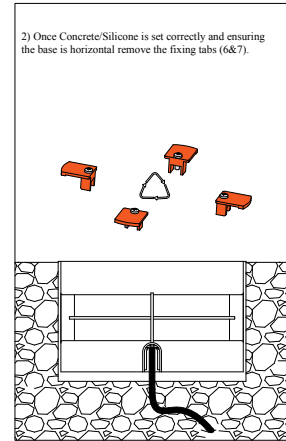
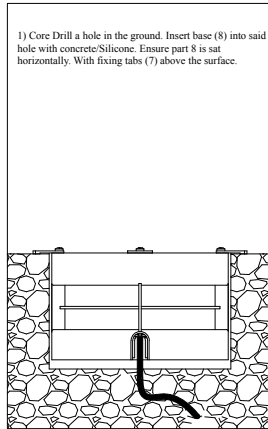
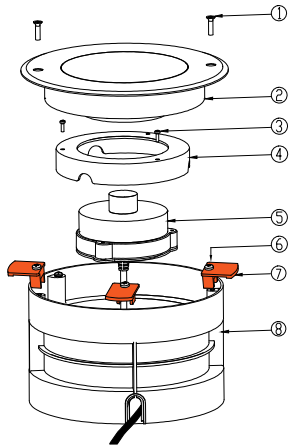

Follow installation instructions carefully. Ensure all below ground termination is totally sealed. Do not shorten the cable lengths provided on the fixture. Ensure all power is Off during installation until circuit is complete.

IP68 Connector:

AL-68CT

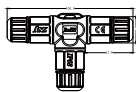

AL-68CS

