

LED Batten T8



Product Spec:

Product Code	Dimension L*W*H [mm]	Power [W]	Input Voltage [V]	Efficiency [lm/W]	Color Temp[K]	CRI	Beam Angle	LED Chip
AL-BT81901-2FT-14W	600*50*52mm	14W	AC220-240V	120lm/W	3000K-6500K	≥80	120°	SMD2835
AL-BT81901-2FT-14WPIR	600*50*52mm	14W	AC220-240V	120lm/W	3000K-6500K	≥80	120°	SMD2835
AL-BT81901-4FT-28W	1200*50*52mm	28W	AC220-240V	120lm/W	3000K-6500K	≥80	120°	SMD2835
AL-BT81901-4FT-28WPIR	1200*50*52mm	28W	AC220-240V	120lm/W	3000K-6500K	≥80	120°	SMD2835
AL-BT81901-5FT-36W	1500*50*52mm	36W	AC220-240V	120lm/W	3000K-6500K	≥80	120°	SMD2835
AL-BT81901-5FT-36WPIR	1500*50*52mm	36W	AC220-240V	120lm/W	3000K-6500K	≥80	120°	SMD2835



■ **Dimension(mm):**

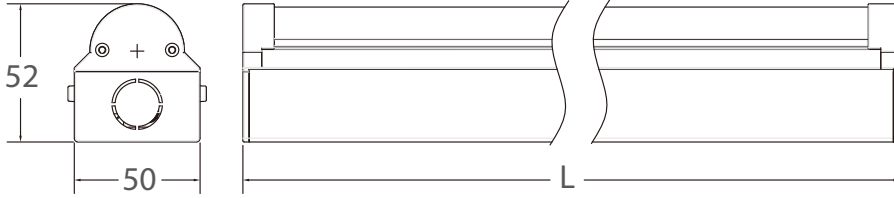

■ **Luminous Intensity Distribution:**

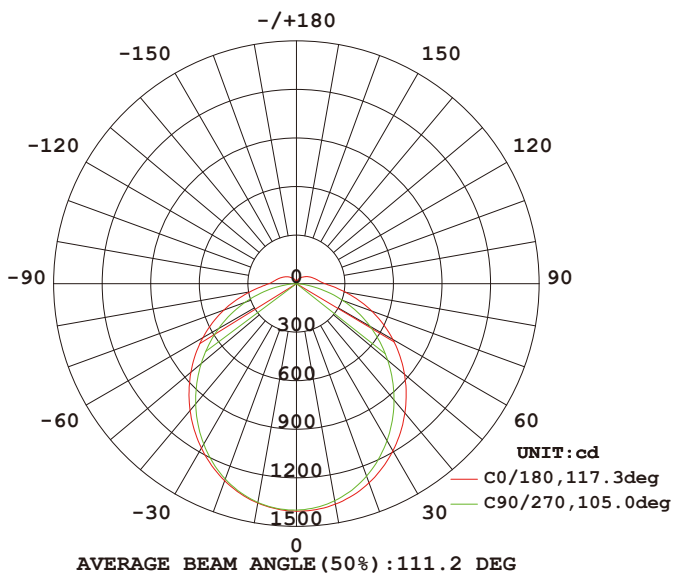

■ **PIR Sensor:**

Sensing Angle

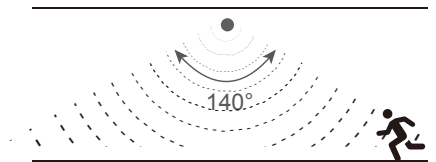

Sensing Distance

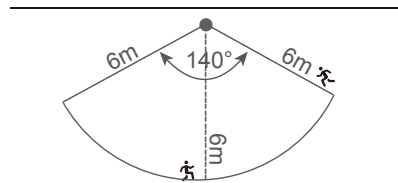

■ **Wiring Method:**

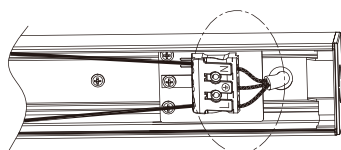

Back wiring

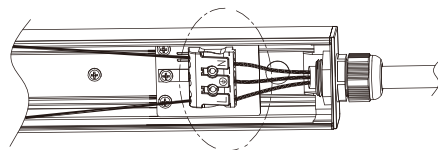

Side wiring

Installation Instructions:

1). Open the lamps, then take out the accessories bag.

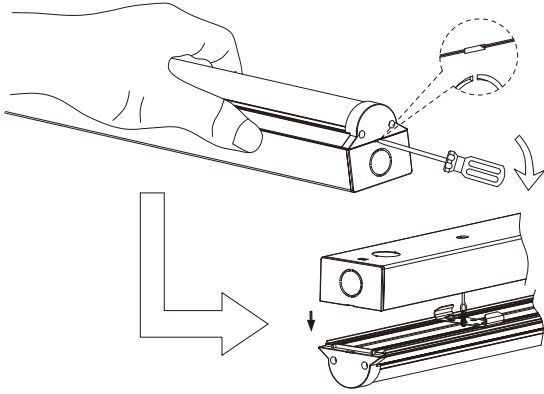

2). Pop out required entry hole, then mount the cable gland.

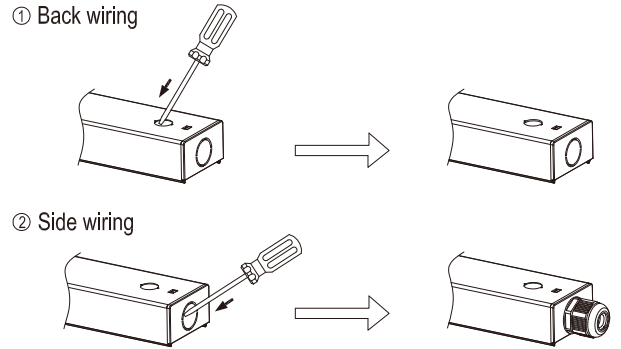

3). Fix the rear aluminium casing to the wall/ceiling.

4). Connected the input wire to the terminal like below.

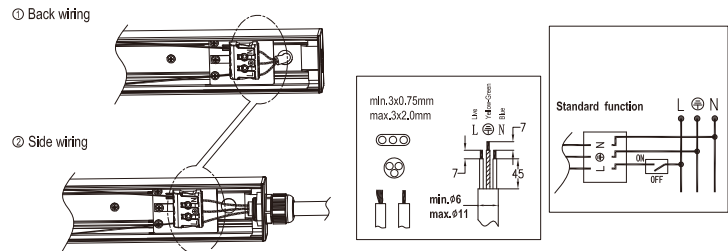
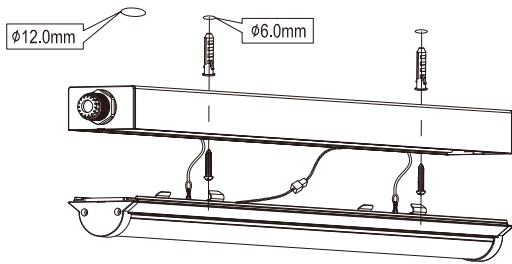

5). Assemble the lamp body on the aluminium casing.

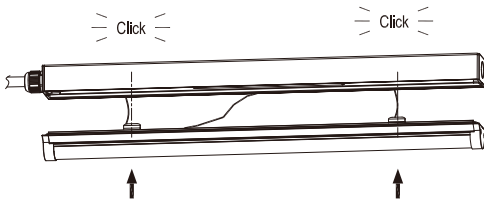

Package Details:

Product Type	Rated Power	Inner Box	Outer Carton	Qty/Carton	Unit N.W	GW/Carton
600mm	10W	608 x 60 x 63mm	625 x 325 x 150mm	10Pcs	500g	6.4Kg
1200mm	17/32W	1208 x 60 x 63mm	1225 x 325 x 150mm	10Pcs	880g	11.3Kg
1500mm	28/56W	1508 x 60 x 63mm	1525 x 325 x 150mm	10Pcs	1080g	14.5Kg
1800mm	32/62W	1808 x 60 x 63mm	1825 x 325 x 150mm	10Pcs	1295g	17.8Kg